



Covered Cantilever Racking

Temporary And Semi-Permanent, Low Cost, Versatile Cantilever Rack-Clad Buildings.



npstructures

built to last



A Heavy-Duty Covered Handling And Storage Solution For Long Or Heavy Products.

The Covered Cantilever Racking is the ideal solution for optimising stock efficiency and reducing your storage footprint. Perfect for external storage where factory and warehouse space is limited and is made for storing long and heavy items such as beams, profiles, pipes and timber. Combined with our Easy-Click Cantilever Racking, it's the perfect storage solution.

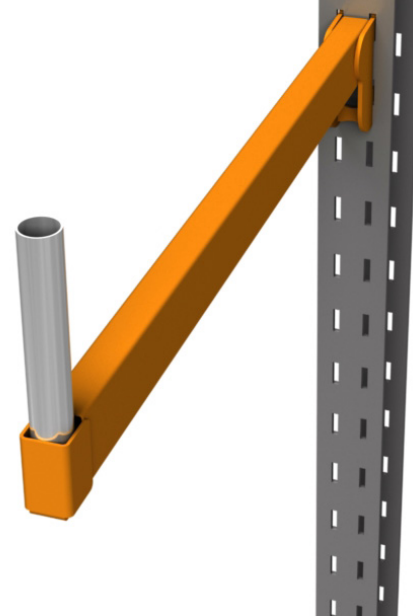

Advantages

Modular and versatile covered warehousing for easy expansion, reduction or relocation.

1

Building And Racking As One.

An economical and space-saving option compared to investing in a traditional steel-framed building and filling it with racking.

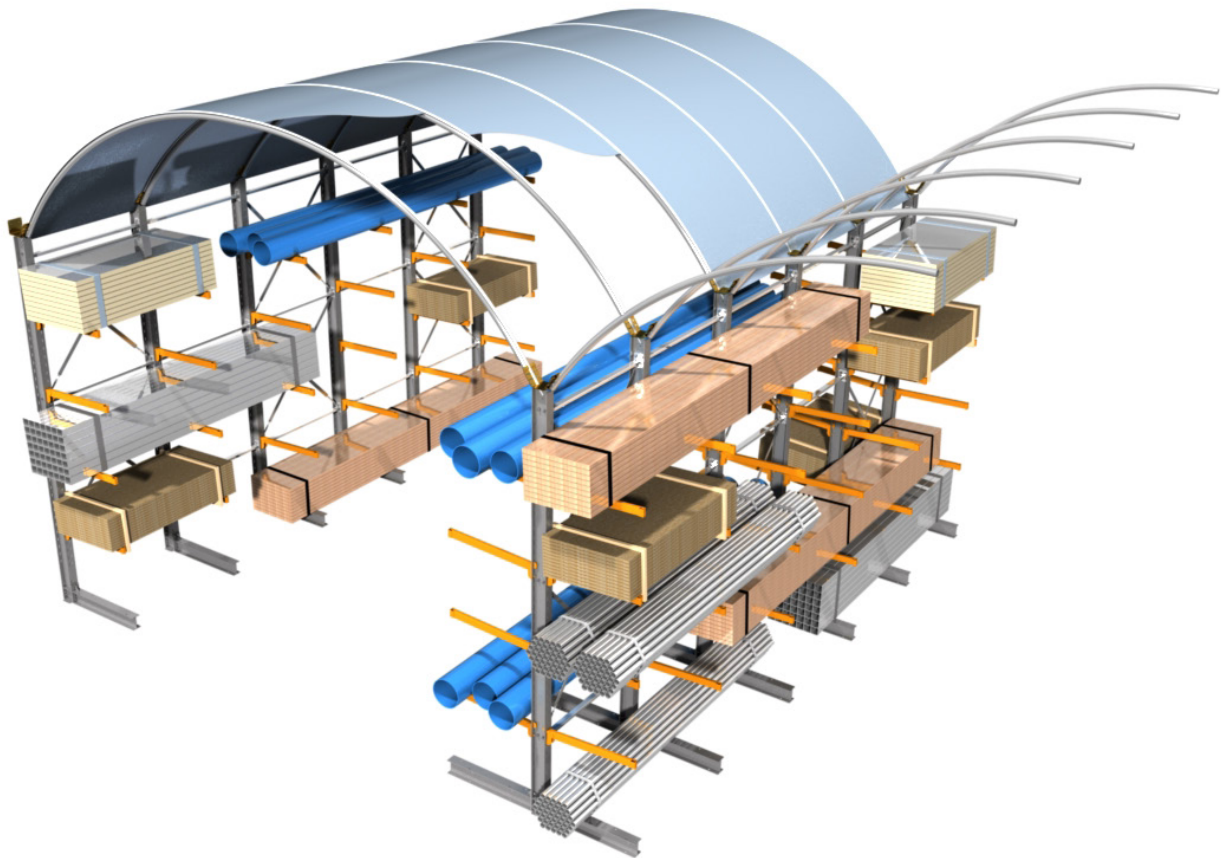

2

Limited Groundworks

Bolts onto a level concrete base for faster construction.

3

Fast Turnaround Time

Limited disruption to your day-to-day operations, get cost-effective covered warehouse space faster than traditional buildings.

4

Economical And Versatile

Fewer ground preparations, faster construction and integrated racking means that a Rack-Clad building is more economical overall.

5

Quality

NP Structures racking is designed to FEM standards.*

*On recent tests at the University of Salford - School of Science, Engineering & the Environment - Commercial Enterprise Unit, our racking arm not only met the FEM requirements but exceeded them.



Superior Benefits

Security and weather protection for externally stored products

Shorter supply and installation lead time compared to traditional buildings

Fully modular system – easily extended, relocated or reduced

Faster Installation Time | Reduced Construction Costs | Lower Operation Costs

Low-Cost | **Faster ROI** | **Minimum Ground Preparation**

Lower Insurance Premiums | Lower Rateable Value

Maximise Storage Space | High storage capacity

Long or Short Term Warehousing Solution Manufactured to Permanent Building Regulations

Quality Assured

Our Warehousing systems comply to the following Standards;

- **BS EN 1991-1-3:2003:** General Actions, Snow Loads.
- **NA to BS EN 1991-1-3:2003:** UK National Annex to Eurocode 1: General Actions, Snow Loads.
- **BS EN 1993-1-4:2005:** General Actions, Wind Loads.
- **NA to BS EN 1991-1-4:2005+A1:2010:** UK National Annex to Eurocode 1: General Actions, Wind Actions.
- **BS 7837:1996 (2015)** and **DIN 4102 (B1):** Specification for flammability performance for textiles used in the construction of marquees and similar textile structures.
- **DESIGNED TO AND EXCEEDS FEM STANDARDS** - On recent tests at the University of Salford - School of Science, Engineering & the Environment - Commercial Enterprise Unit, our racking arm not only met the FEM requirements but exceeded.

Increase Your Storage Space

Without expensive relocation costs, warehouse expansions and disruption to operations.

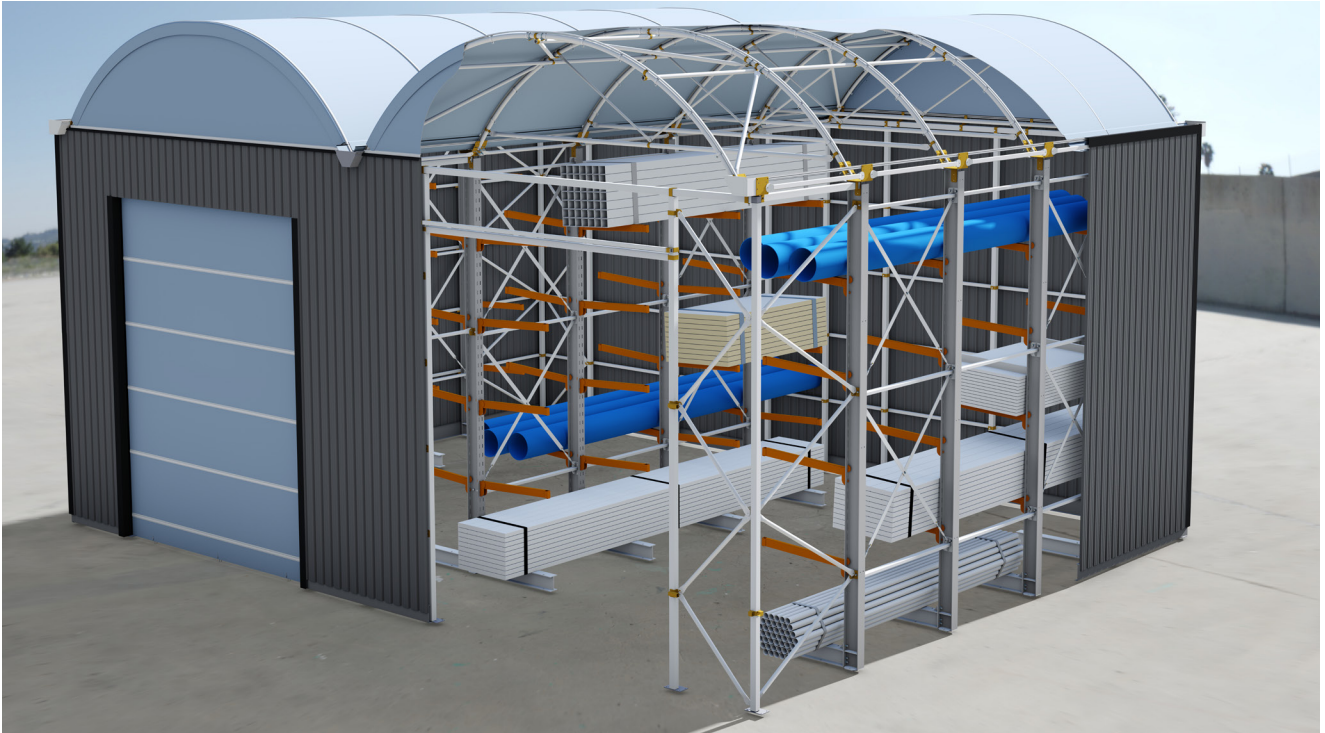

Width per bay	Overall Height	Height to the Eaves	Length	Aisle Width	Side Cladding	Finish
6.5m	7.5m	6m	From 6m	3.5m	Corrugated Tin Sheeting	Painted Powder Coated Galvanised Steel

Complete Protection From The Elements

Our **STRIPFIX**® system allows covers to be more effectively tensioned, protecting against weather damage and creating a drum-skin tight finish. Individual strips provide cost-effective maintenance of your canopy and faster installation in windy conditions compared to a single sheet.

STRIPFIX® systems feature aluminium rails fixed to the framework, into which PVC sheets are simply slid into position creating a skin-tight membrane.

All The Strength Of A Traditional Building Without The Expense.

NP Structures' PVC-Clad Rack buildings are designed by our in-house structural engineers to BS standards. For all of the strength and durability of a traditional warehousing building for a fraction of the construction time and cost.

Our heavy-duty cantilever racking has been manufactured to be robust enough to form part of the building's structure, adding to the overall strength and integrity of its frame. This allows for more usable space for storage and manoeuvring.

Manufactured from Z35 pre-galvanised steel box section and galvanised steel tube.

Unique Design Features

Our Easy-Click arm system allows you to connect an arm to the column without bolting or complicated fixing plates. Designed to simply slot in and lock down to save valuable time.

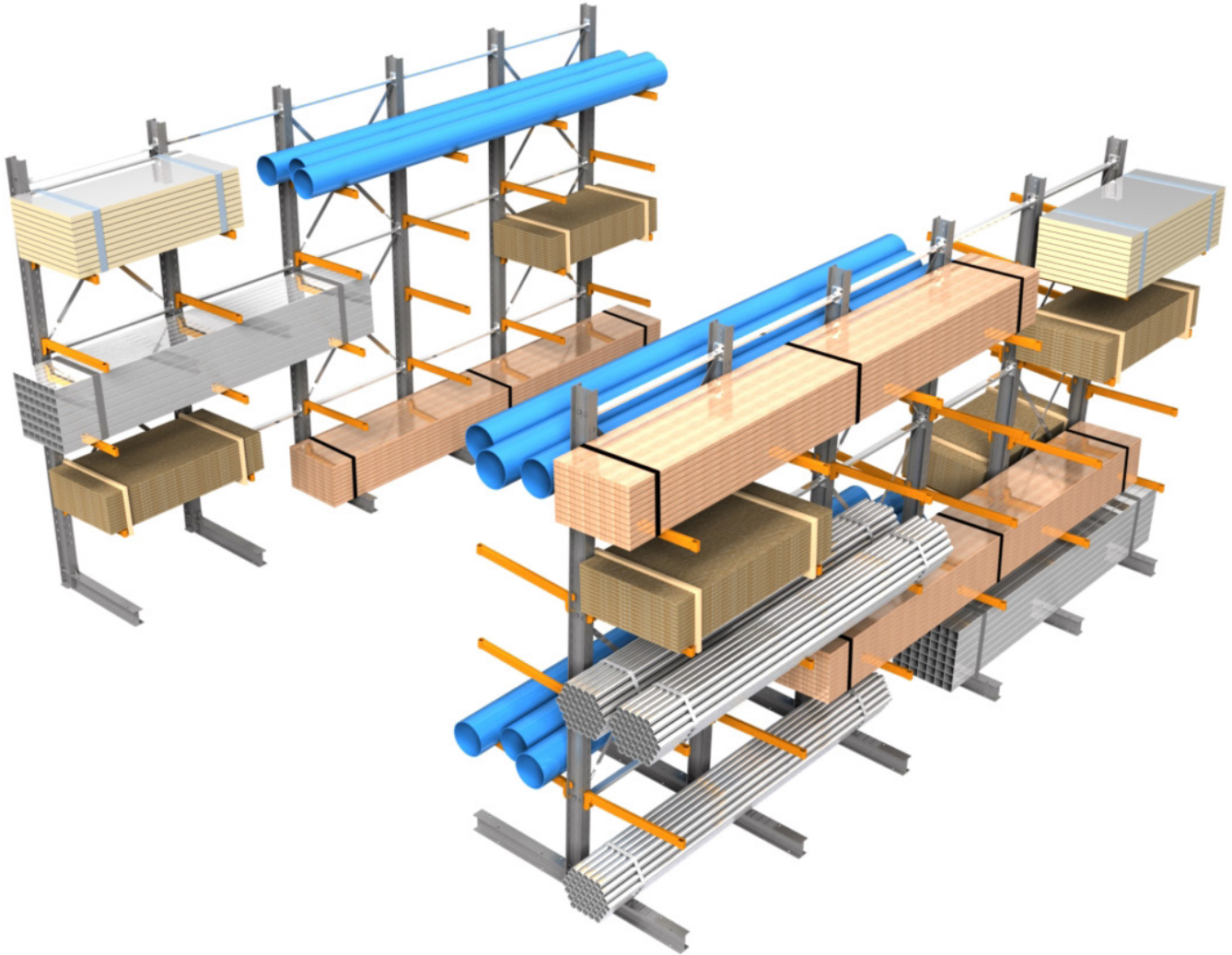

Heavy-Duty Cantilever Racking

Our heavy-duty cantilever racking is designed to effectively store heavy loads manoeuvred by both automatic and manual handling systems. Cantilever racking is suitable for a diversity of load units, and is the best storage system for plastic tubing, timber, PVC extrusions, metal profiles and all other long products.

Unique design features include heavy-duty click-fit connection arms, that are hooked vertically into the upright, creating a flexible position that does not require bolting in place. The hooking arms are designed for easier storage management and to prevent damage to the support arm and upright.

Although racking is adjustable, once the beams are slotted into position in the frame uprights, an inter-locking structure of great strength and rigidity is maintained.

Our cantilever racking has been designed to fit with our PVC roofing and cladding systems so that the racking forms the structural element of the building, which lets us produce low cost relocated warehouse solutions.



Our Easy-Click arm system allows you to connect an arm to the column without bolting or using complicated fixing plates. Simply slot in and pivot the arm down, this saves valuable time when the racks need configuring for different products.

The design of the locking system will not allow the arm to disengage until it has been lifted above 45 degrees from its fitted position, this is an added safety feature stopping arms being disconnected accidentally.

Our Easy-Click system also gives extra protection to the rack columns from forklift collision as it acts as a pivot moving upwards and sideways to absorb any impact and saving expensive repair costs.

Pivoting Arms For Damage Protection And Flexibility.

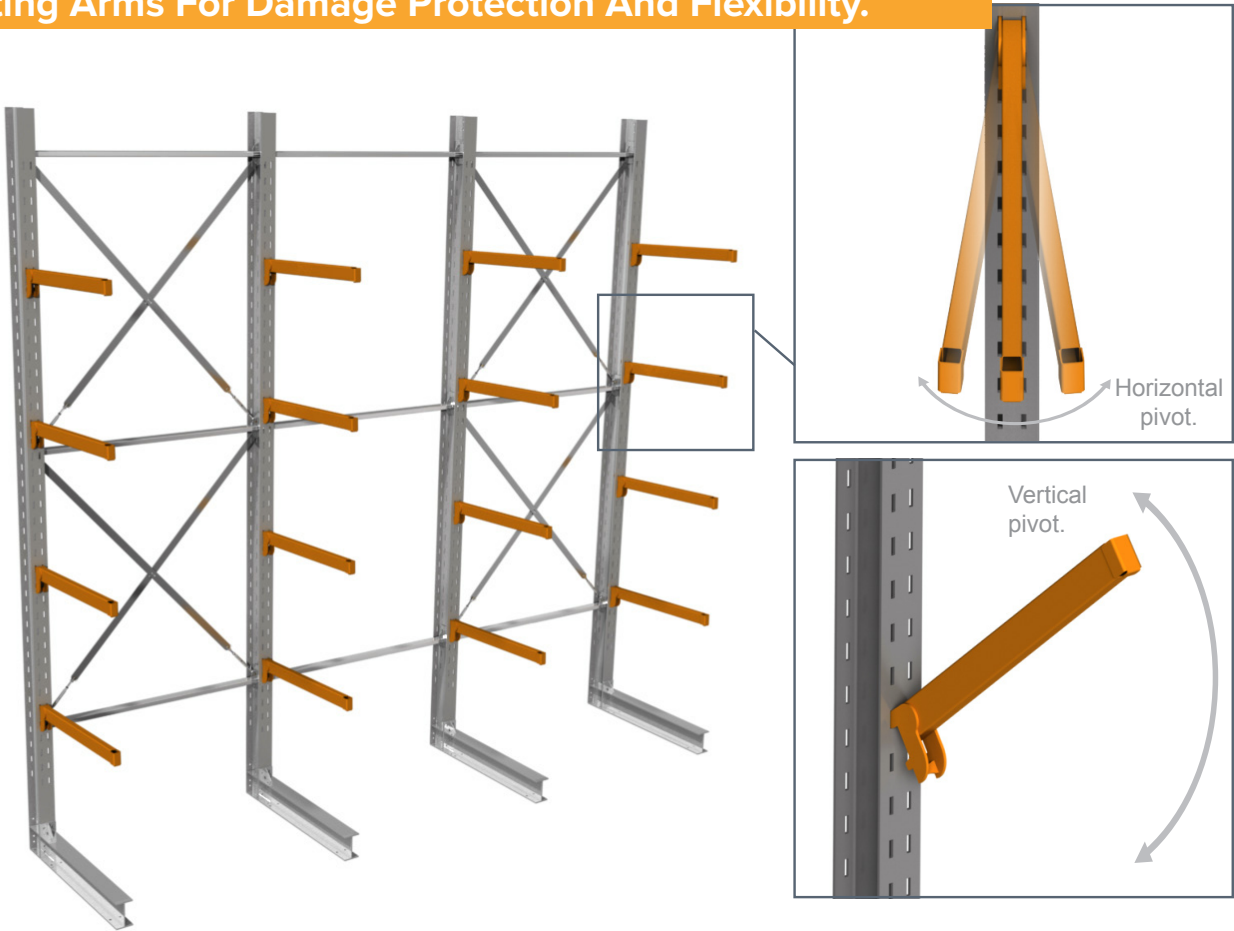

Optimise Warehouse Space

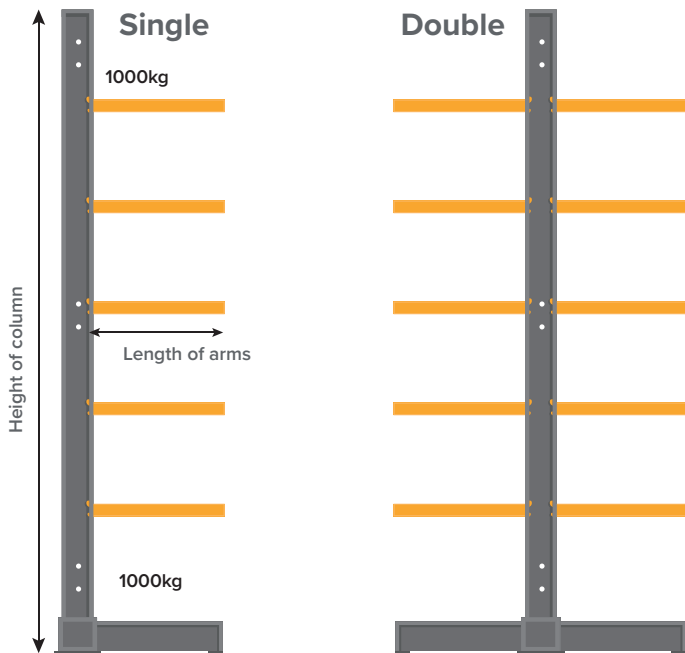

The columns and bases are manufactured from heavy-duty universal beams.

Arms can be fitted to either side of the columns forming double or single-sided racks, with a height adjustment of 125mm intervals.

Our standard arms are capable of 1000kg per arm and each upright has been designed to take a maximum load of 10,000kg per column.

See below for the various options available.

Detail		Options					
Height of Columns		3m	3.5m	4m	4.5m	5m	5.72m
Length of Arms		1000mm			1250mm		
No of Arms		Single Column - No. of arms as required, total weight not to exceed 5000kg			Double-Sided - No. of arms as required, total weight not to exceed 10'000kg		
Height Between Arms		Height adjustment of 125mm intervals.					
Spacings (between columns)		1m	1.2m	1.5m	2m		
Sides		Single-Sided			Double-Sided		
Finish	Arms	Powder Coated – Standard NP colour to RAL2011 Deep Orange (Gloss) - Other colours available*				Galvanised	
	Columns	Powder Coated - Other colours available*				Galvanised	

*We're happy to accommodate any colour request though this will mean a longer lead time, a minimum order quantity and all colour request orders are noncancellable.



Call our dedicated sales team on 01282 8731116 for more information.