



Cantilever Racking

Sturdy Storage Solutions For Heavy, Long Or Variable Length Loads



npstructures

built to last





A Heavy-Duty Handling and Storage Solution for Long or Heavy Products.



Our cantilever racking is specially designed to house long or varied load units including metallic profiles, pipes, mouldings, timber or sheet materials.

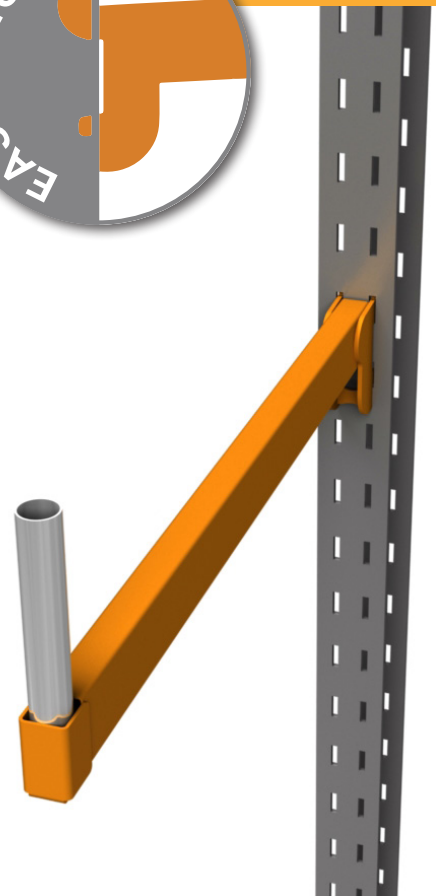

Advantages

Maximum versatility to adapt to any warehouse type. Our unique design feature allows fast installation and re-configuration.

1

Space Saving

Easily configurable to adjust to different heights.

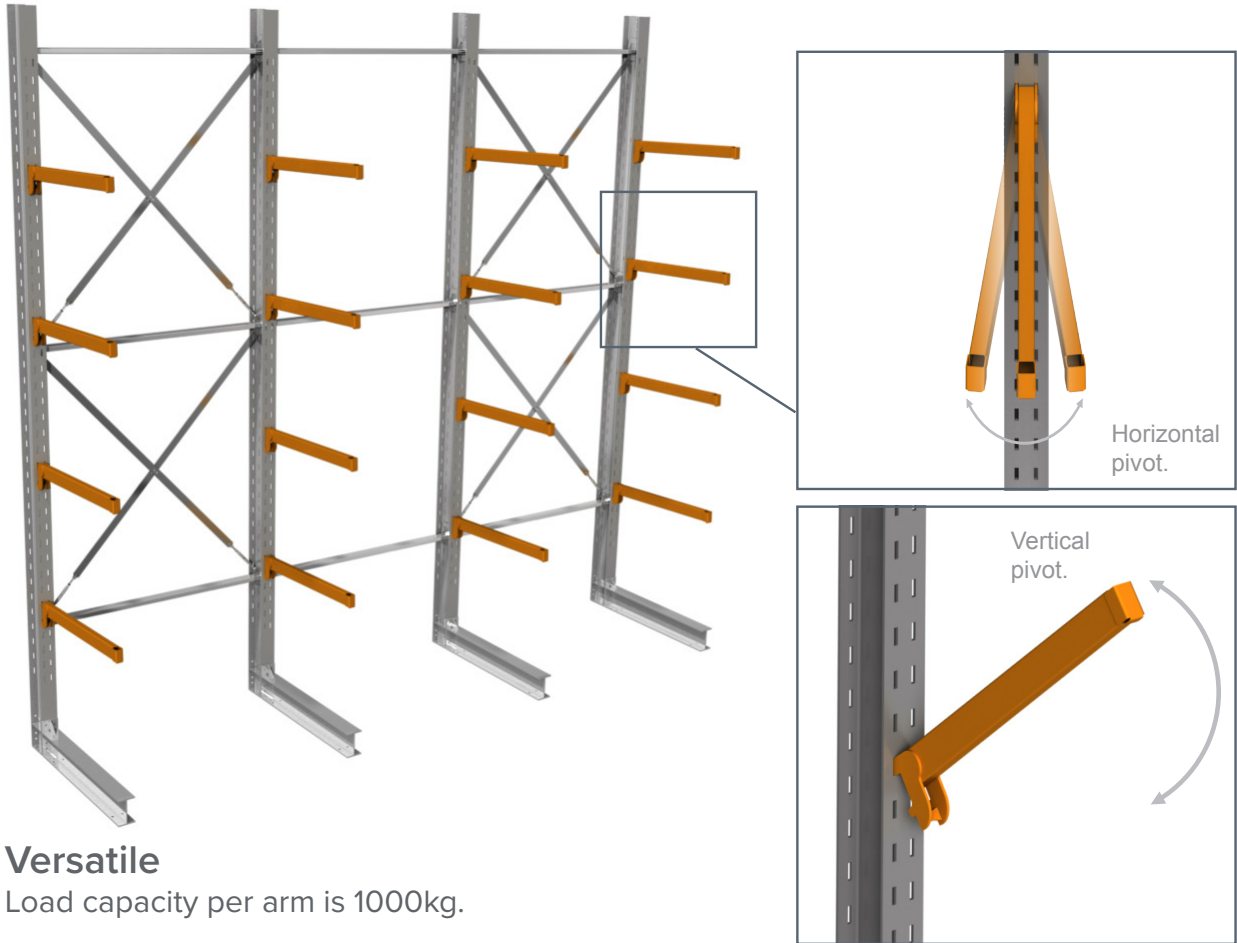

2

Versatile

Load capacity per arm is 1000kg.

3

Fast & Easy To Assemble

Easy-Click arms are designed to securely lock onto the uprights without requiring bolts.

4

Safety Features

Horizontal and vertical pivoting arms protect the framework, preventing damaged caused by machinery.

5

Quality

NP Structures Racking Is Designed To and Exceeds FEM Standards*.

*On recent tests at the University of Salford - School of Science, Engineering & the Environment - Commercial Enterprise Unit, our racking arm not only met the FEM requirements but exceeded them by a further 10%.

Unique Design Features

Our Easy-Click arm system allows you to connect an arm to the column without bolting or complicated fixing plates.

Designed to simply slot in and lock down to save valuable time.

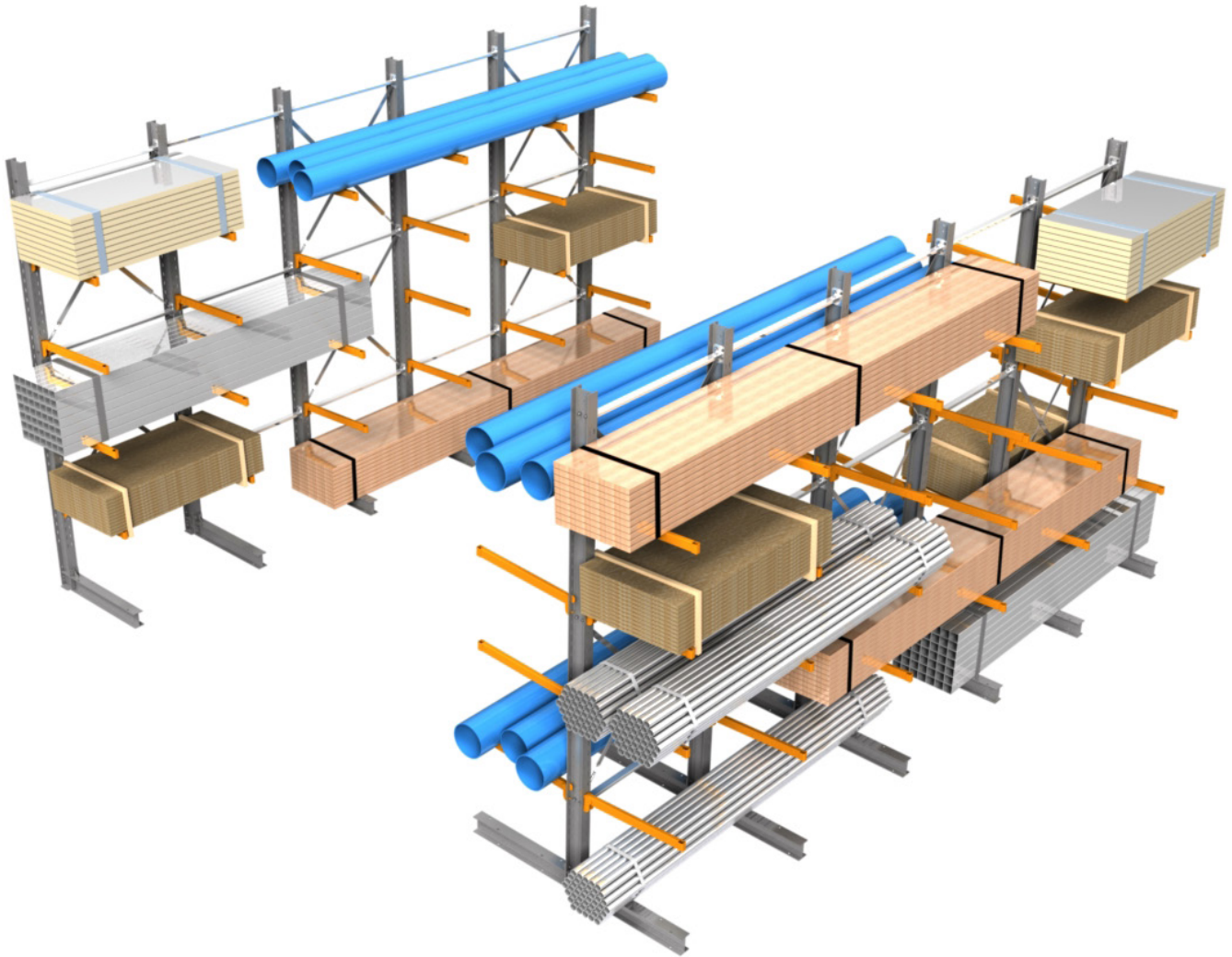

Heavy-Duty Cantilever Racking

Our heavy-duty cantilever racking is designed to effectively store heavy loads manoeuvred by both automatic and manual handling systems. Cantilever racking is suitable for a diversity of load units, and is the best storage system for plastic tubing, timber, PVC extrusions, metal profiles and all other long products.

Unique design features include heavy-duty click-fit connection arms, that are hooked vertically into the upright, creating a flexible position that does not require bolting in place. The hooking arms are designed for easier storage management and to prevent damage to the support arm and upright.

Although racking is adjustable, once the beams are slotted into position in the frame uprights, an inter-locking structure of great strength and rigidity is maintained.

Our cantilever racking has been designed to fit with our PVC roofing and cladding systems, so that the racking forms the structural element of a building, which can produce a low-cost pop-up warehouse solution.



Easy-Click System

Our Easy-Click arm system allows you to connect an arm to the column without bolting or using complicated fixing plates. Simply slot in and pivot the arm down this save valuable time when the racks need configuring for different products.

The design of the locking system will not allow the arm to disengage until it has been lifted up above 45 degrees from its fitted position, this is an added safety feature stopping arms being disconnected accidentally.

Our Easy-Click system also gives extra protection to the rack columns from forklift collision as it acts as a pivot moving upwards and sideways to absorb any impact and saving expensive repair costs.

Quality Assured

Our Racking systems comply to the following Standards;

- FEM Code of practice for the design and use of cantilever racking systems.
- Physically Tested at University of Salford, School of Science, Engineering & the Environment, Commercial Enterprise Unit for Bending Tests and Shear Tests to determine structural performance to FEM standards.

Superior Benefits

Our Racking systems offer a wide range of benefits for every business. Including;

- Fully modular system – easily extended, relocated or reduced.
- Faster Installation Time | Easy-Click arms removes the requirement for bolting during installation and adjustment.
- Maximise Storage Space | High storage capacity.
- Not a Pin & Cotter system, so no missing pins or unusable arms.



High-Strength And Versatile

Our standard arms are capable of over 1000kg per arm and each upright has been designed to take a maximum load of 5,000kg per side (10,000kg per double sided column).

Each load must be supported by at least two arms. Products may protrude from the sides of both arms by up to 50% of the horizontal distance between adjacent arms. Our columns are spaced at 2m, allowing a 1m overlap at each side.

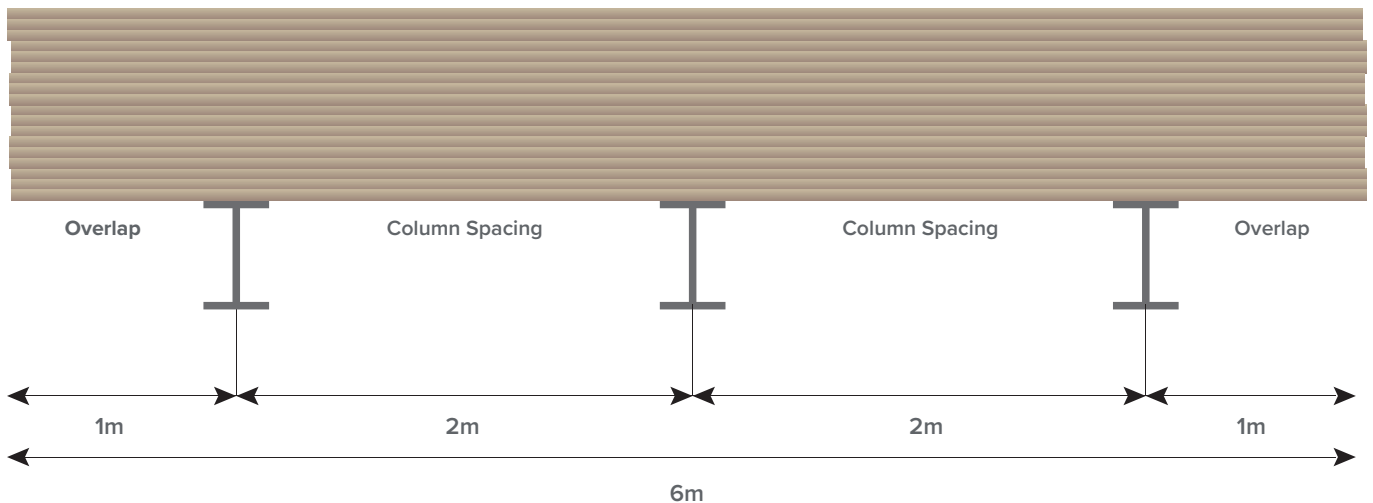

As per diagram: Max. load per arm X 3 columns = 3000kg

Optimum Warehouse Space

Warehouses are typically laid out with single and double sided cantilever racking for best use of warehouse space.

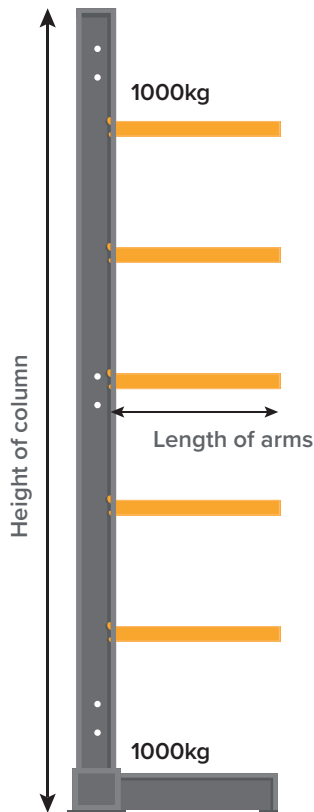

Single

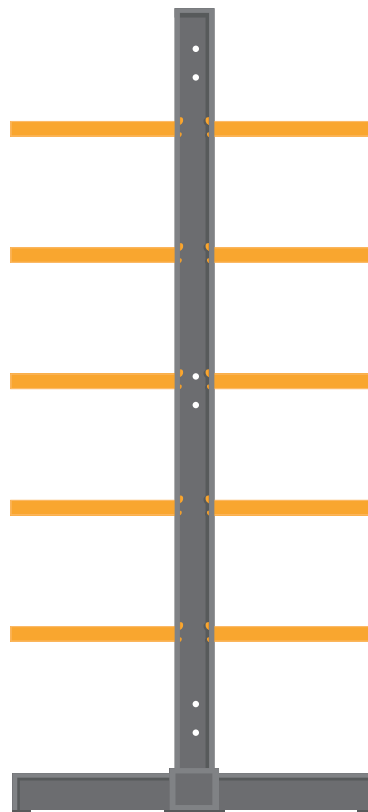

Double

The columns and bases are manufactured from heavy duty universal beams.

Arms can be fitted to either side of the columns forming double or single sided racks, with height adjustment of 125mm intervals.

Our standard arms are capable of 1000kg per arm and each upright has been designed to take a maximum load of 10,000kg per column.

See below for the various options available.

Detail		Options					
Height of Columns		3m	3.5m	4m	4.5m	5m	5.72m
Length of Arms		1000mm			1250mm		
No of Arms		Single Column - No. of arms as required, total weight not to exceed 5000kg			Double-Sided - No. of arms as required, total weight not to exceed 10'000kg		
Height Between Arms		Height adjustment of 125mm intervals.					
Spacings (between columns)		1m	1.2m	1.5m	2m		
Sides		Single-Sided			Double-Sided		
Finish	Arms	Powder Coated – Standard NP colour to RAL2011 Deep Orange (Gloss) - Other colours available*				Galvanised	
	Columns	Powder Coated - Other colours available*				Galvanised	

*We're happy to accommodate any colour request though this will mean a longer lead time, a minimum order quantity and all colour request orders are noncancellable.

Covered Racking

Why buy a building to put racking inside, when you can save valuable warehouse space with PVC Rack-Clad buildings?



Unique design features include heavy-duty Quick-Fit connection arms, that are hooked vertically into the upright, creating a flexible position that does not require bolting in place. The hooking arms are designed for easier storage management and to prevent damage to the support arm and upright.

Clad in heavy-duty PVC-coated fabric and featuring our unique STRIPFIX® cladding system on the roof; the Rack-Clad Structure provides exceptional weather resistance for external storage applications.

Our STRIPFIX® system allows covers to be more effectively tensioned, protecting against weather damage and creating a drum-skin tight finish. Individual strips provide cost-effective maintenance of your canopy and is easily repaired should damage occur.

Call our dedicated sales team on 01282 873116 for more information.

